

**PLAN URBANISTIC ZONAL  
P.U.Z.**

PLAN URBANISTIC ZONAL, PENTRU construire LOCUINTE SI SEDIU FIRMA  
AMPLASAMENT-COM. MAGURA, SAT MAGURA (extravilan), JUD. BACAU  
BENEFICIARI:  
PUSCASU PAUL CODRIN si PUSCASU NICOLETA ELENA,  
PUSCASU GHEORGHE si PUSCASU TUDORA, CIUBOTARU- FRIGILINTE  
ALEXANDRU si CIUBOTARU-FIGILINTE IULIANA, COZMA NECULAI si  
COZMA ELENA, S.C CONSISERV CONSTRUCT SRL

**2. SITUATIA EXISTENTA**

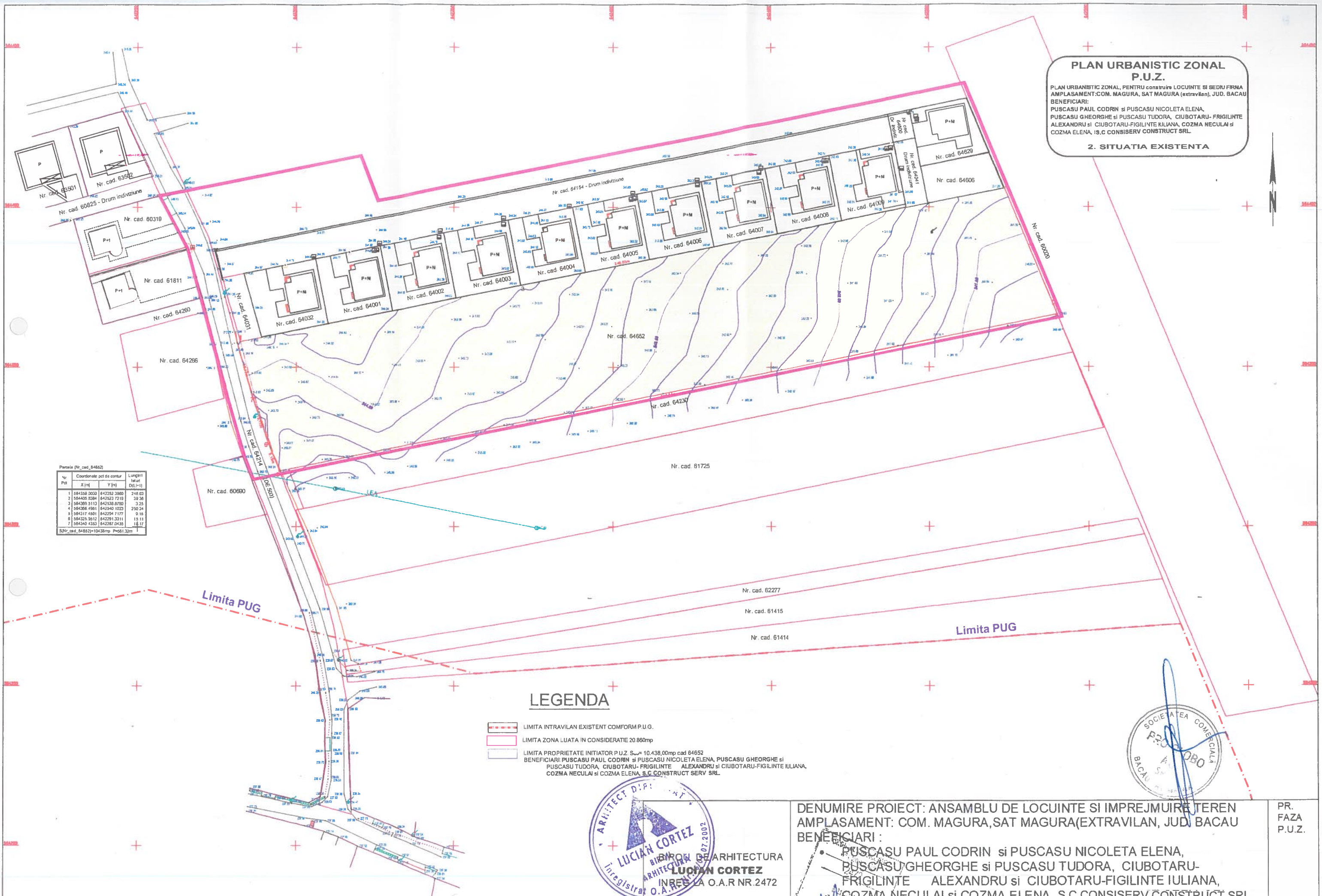

Panella (Nr. cad. 64652)

| Nr. Pct. | Coordonate pct de contur<br>X [m] Y [m] | Longh1<br>latet<br>D(L+1) |
|----------|---|---------------------------|
| 1        | 384328 3032 642282 3800                 | 246.03                    |
| 2        | 384405 5384 642523 7210                 | 39.36                     |
| 3        | 384389 5119 642538 8703                 | 3.25                      |
| 4        | 384386 4961 642540 1023                 | 250.24                    |
| 5        | 384317 4801 642294 7177                 | 9.16                      |
| 6        | 384323 3812 642291 3311                 | 15.11                     |
| 7        | 384340 4353 642287 0435                 | 18.17                     |

S(Nr. cad. 64652)=10438mp Ph=61.32m

**LEGENDA**

- LIMITA INTRAVILAN EXISTENT COMFORM P.U.G.
- LIMITA ZONA LUATA IN CONSIDERATIE 20.880mp
- LIMITA PROPRIETATE INITIATOR P.U.Z. S<sub>prop</sub> = 10.438,00mp cad 64652  
BENEFICIARI PUSCASU PAUL CODRIN si PUSCASU NICOLETA ELENA, PUSCASU GHEORGHE si  
PUSCASU TUDORA, CIUBOTARU- FRIGILINTE ALEXANDRU si CIUBOTARU-FIGILINTE IULIANA,  
COZMA NECULAI si COZMA ELENA, S.C CONSISERV CONSTRUCT SERV SRL.



DENUMIRE PROIECT: ANSAMBLU DE LOCUINTE SI IMPREJMUIRE TEREN  
AMPLASAMENT: COM. MAGURA, SAT MAGURA (EXTRAVILAN), JUD. BACAU  
BENEFICIARI:  
PUSCASU PAUL CODRIN si PUSCASU NICOLETA ELENA,  
PUSCASU GHEORGHE si PUSCASU TUDORA, CIUBOTARU-  
FRIGILINTE ALEXANDRU si CIUBOTARU-FIGILINTE IULIANA,  
COZMA NECULAI si COZMA ELENA, S.C CONSISERV CONSTRUCT SRL.



|           |                |             |
|-----------|----------------|-------------|
| PROIECTAT | Arh. Cortez L. | Sc = 1/500  |
| DESENAT   | Arh. Cortez L. | Data : 2018 |

**SITUATIA EXISTENTA**

PR. FAZA  
P.U.Z.  
PL. U2